

G:\Current Projects\06227.dwg\PLANNING\EXHIBITS\12-18-18\06227-Marketing Exhibit 6-28-21.dwg, 6/28/2021 3:36:32 PM, DWG To PDF.pc3, 1:1

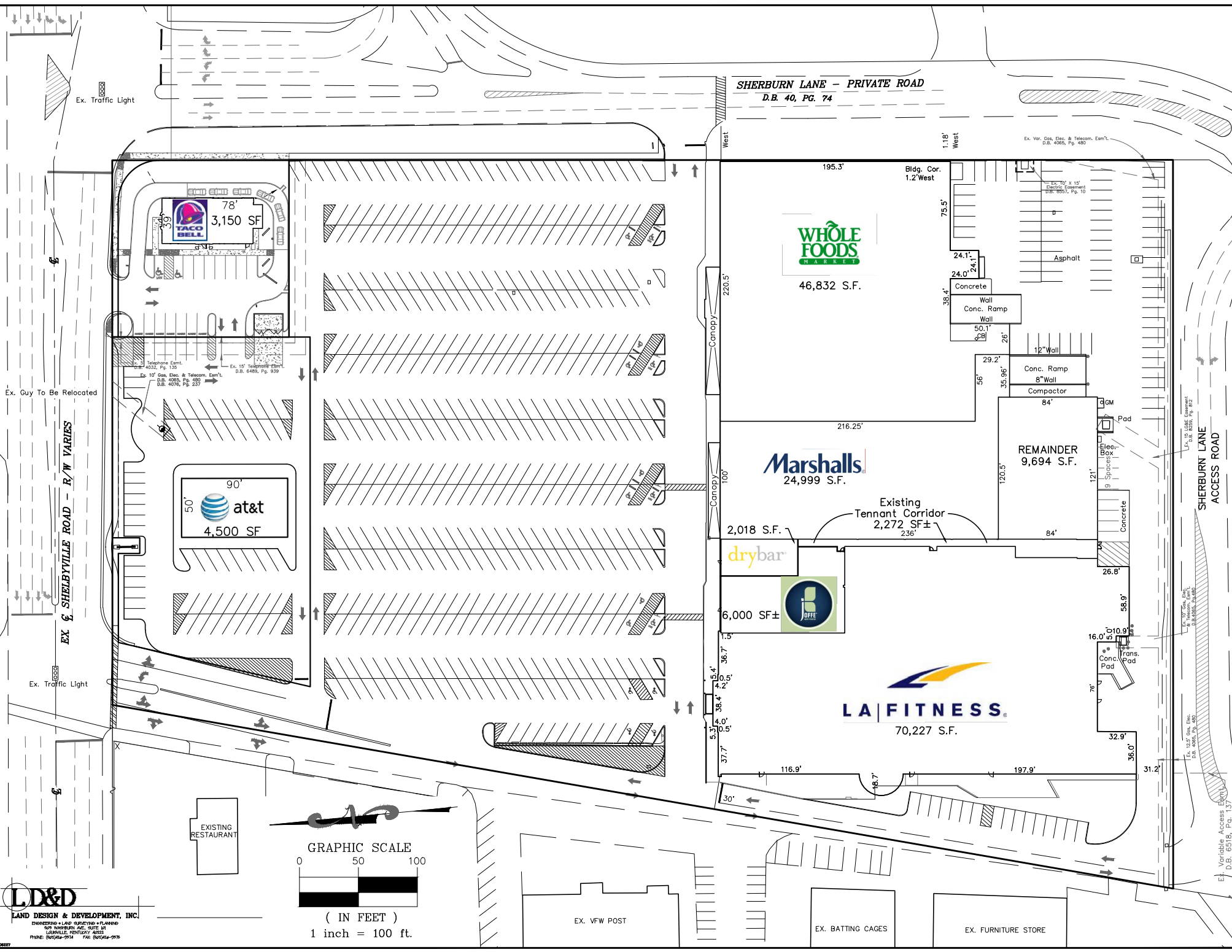

SHERBURN LANE - PRIVATE ROAD
D.B. 40, PG. 74

TACO BELL
78'
3,150 SF

at&t
50'
90'
4,500 SF

WHOLE FOODS
MARKET
46,832 S.F.

Marshalls
24,999 S.F.

drybar
6,000 SF±

OFFICE

LA FITNESS
70,227 S.F.

REMAINDER
9,694 S.F.

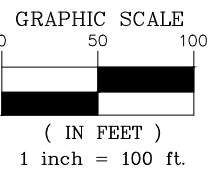

LD&D
LAND DESIGN & DEVELOPMENT, INC.
ENGINEERING • LAND SURVEYING • PLANNING
509 WASHINGTON AVE. SUITE 100
LEWISVILLE, OHIO 44641
PHONE: 800.642.2914 FAX: 800.642.2915

EX. VFW POST

EX. BATTING CAGES

EX. FURNITURE STORE

EXISTING RESTAURANT

Ex. Var. Cak, Elec. & Telecom. Esm't.
D.B. 4065, Pg. 480

Ex. 10' x 10' x 10'
Electric Enclosure
D.B. 4057, Pg. 10

Telephone Esm't.
D.B. 4032, Pg. 135

Ex. 10' Gas, Elec. & Telecom. Esm't.
D.B. 4059, Pg. 285

Ex. 15' Telephone Esm't.
D.B. 6489, Pg. 939

Ex. 10' x 10' x 10'
Electric Enclosure
D.B. 4057, Pg. 10

Ex. 10' Gas, Elec. & Telecom. Esm't.
D.B. 4059, Pg. 285

Ex. 10' Gas, Elec. & Telecom. Esm't.
D.B. 4059, Pg. 285

Ex. Variable Access Esm't.
D.B. 6518, Pg. 137

SHERBURN LANE
ACCESS ROAD

Ex. Guy To Be Relocated

EX. SHELBYVILLE ROAD - R/W VARIES

Ex. Traffic Light

Ex. Traffic Light

Bldg. Cor.
1.2' West

1.18' West

West

Canopy

Canopy

Canopy

Canopy

Canopy

Concrete

Concrete

Concrete

Concrete

Concrete

Asphalt

Conc. Ramp

Compactor

8' Wall

12" Wall

84'

26.8'

56.9'

10.9'

16.0'

32.9'

36.0'

31.2'

116.9'

197.9'

30'

37.7'

40.5'

38.4'

15.4'

36.7'

1.5'

56'

35.96'

120.5'

84'

29.2'

24.1'

24.1'

75.5'

38.4'

50.1'

26'

26.8'

76'

31.2'

116.9'

197.9'

195.3'

220.5'

216.25'

100'

2,018 S.F.

2,272 SF±

236'

100'

100'

100'

1.18' West

1.18' West

1.18' West

1.18' West

1.18' West

1.18' West

1.18' West

1.18' West

1.18' West

1.18' West

1.18' West

1.18' West

1.18' West

1.18' West

1.18' West

1.18' West

1.18' West

1.18' West

1.18' West

1.18' West

1.18' West

1.18' West

1.18' West

1.18' West

1.18' West

1.18' West

1.18' West

1.18' West

1.18' West

1.18' West

1.18' West

1.18' West

1.18' West

1.18' West

1.18' West

1.18' West

1.18' West

1.18' West

1.18' West

1.18' West

1.18' West

1.18' West

1.18' West

1.18' West

1.18' West

1.18' West

1.18' West

1.18' West

1.18' West

1.18' West

1.18' West

1.18' West

1.18' West

1.18' West

1.18' West

1.18' West

1.18' West

1.18' West

1.18' West

1.18' West

1.18' West

1.18' West

1.18' West

1.18' West

1.18' West

1.18' West

1.18' West

1.18' West

1.18' West

1.18' West

1.18' West

1.18' West

1.18' West

1.18' West

1.18' West

1.18' West

1.18' West

1.18' West

1.18' West

1.18' West

1.18' West

1.18' West

1.18' West

1.18' West

1.18' West

1.18' West

1.18' West

1.18' West

1.18' West

1.18' West

1.18' West

1.18' West

1.18' West

1.18' West

1.18' West

1.18' West

1.18' West

1.18' West

1.18' West

1.18' West

1.18' West

1.18' West

1.18' West

1.18' West

1.18' West

1.18' West

1.18' West

1.18' West

1.18' West

1.18' West

1.18' West

1.18' West

1.18' West

1.18' West

1.18' West

1.18' West

1.18' West

1.18' West

1.18' West

1.18' West

1.18' West

1.18' West

1.18' West

1.18' West

1.18' West

1.18' West

1.18' West

1.18' West

1.18' West

1.18' West

1.18' West

1.18' West

1.18' West

1.18' West

1.18' West

1.18' West

1.18' West

1.18' West

1.18' West

1.18' West

1.18' West

1.18' West

1.18' West

1.18' West

1.18' West

1.18' West

1.18' West

1.18' West

1.18' West

1.18' West

1.18' West

1.18' West

1.18' West

1.18' West

1.18' West

1.18' West

1.18' West

1.18' West

1.18' West

1.18' West

1.18' West

1.18' West

1.18' West

1.18' West

1.18' West

1.18' West

1.18' West

1.18' West

1.18' West

1.18' West

1.18' West

1.18' West

1.18' West

1.18' West

1.18' West

1.18' West

1.18' West

1.18' West

1.18' West

1.18' West

1.18' West

1.18' West

1.18' West

1.18' West

1.18' West

1.18' West

1.18' West

1.18' West

1.18' West

1.18' West

1.18' West

1.18' West

1.18' West

1.18' West

1.18' West

1.18' West

1.18' West

1.18' West

1.18' West

1.18' West

1.18' West

1.18' West

1.18' West

1.18' West

1.18' West

1.18' West

1.18' West

1.18